

STATUS :

**PLANNING**

THIS DRAWING HAS BEEN PREPARED SOLELY FOR THE PURPOSE OF PLANNING PERMISSION. THIS DRAWING IS NOT TO BE RELIED UPON FOR CONSTRUCTION AND NO GUARANTEE IS GIVEN AS TO ITS SUITABILITY FOR CONSTRUCTION.

ORIENTATION :

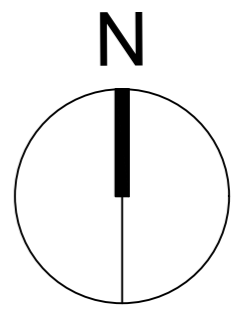

NOTES :

- = EXTENTS OF PLANNING APPLICATION SITE OUTLINED IN RED
- X** = LOCATION OF SITE NOTICE(S)

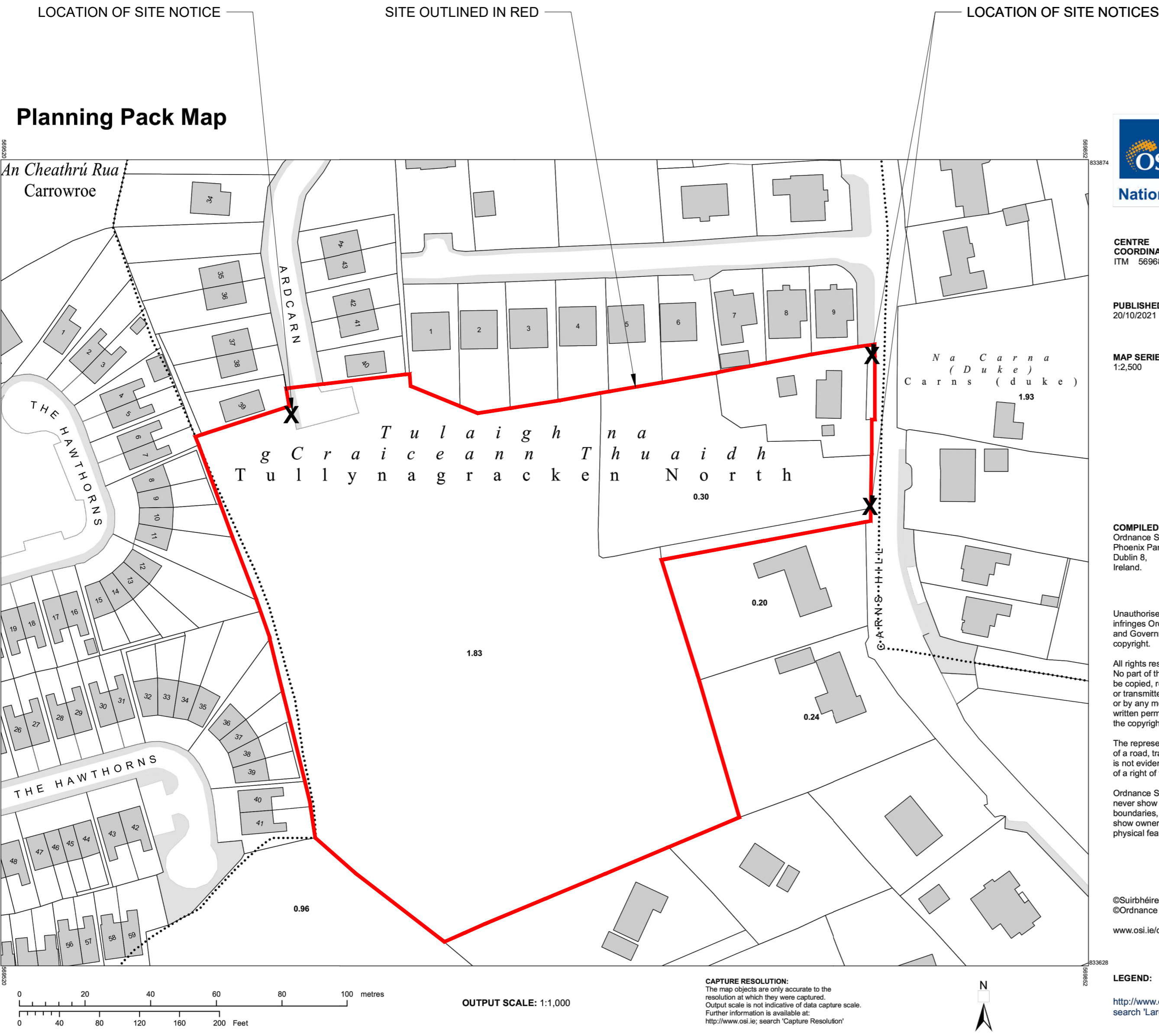

**01 OS URBAN PLACE SITE LOCATION MAP**  
1:1,000 @ A1

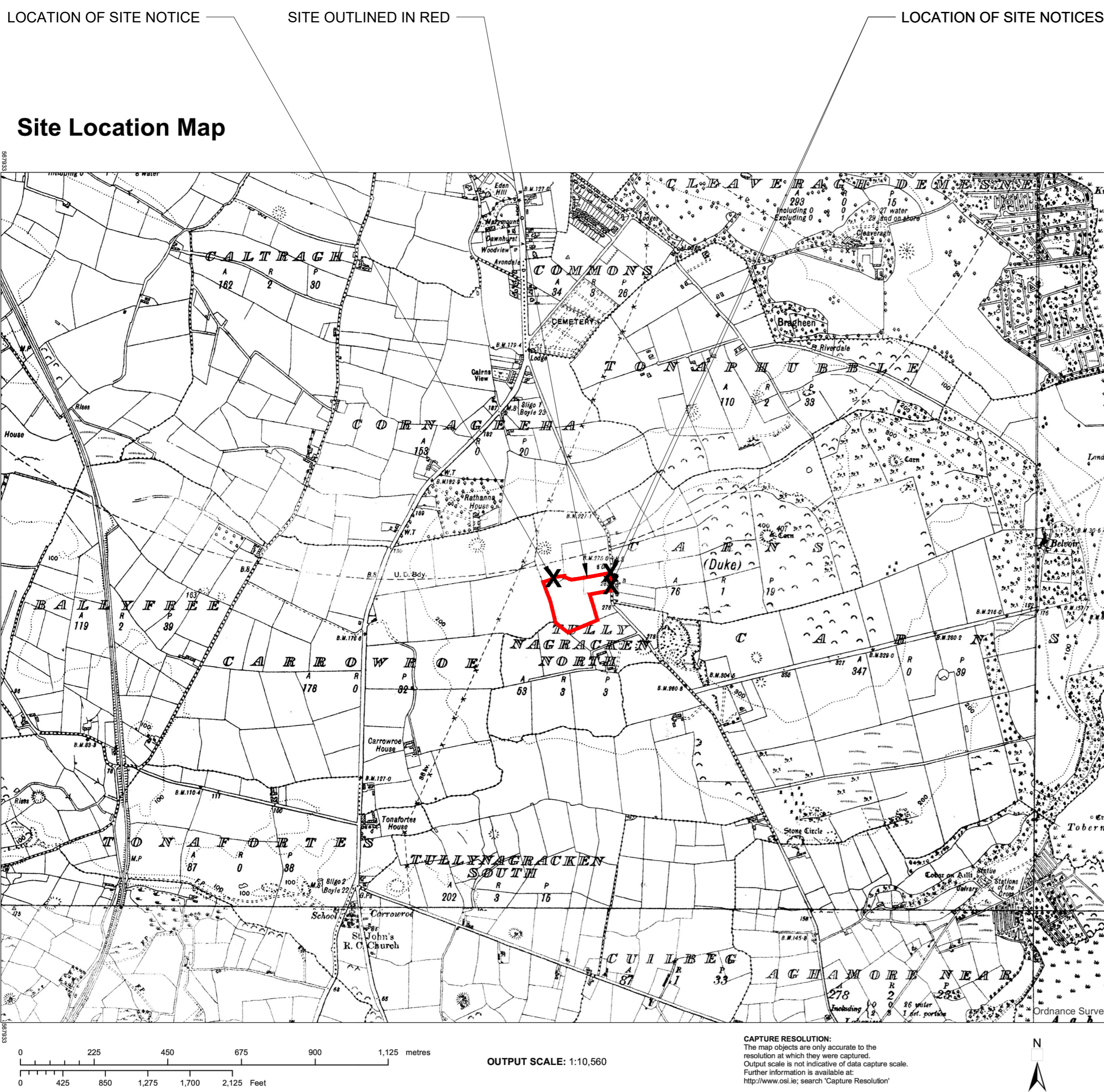

**02 OS 6-INCH SITE LOCATION MAP**  
1:10,560 @ A1

O.S. Authorised Internet Planning Pack Maps purchased from Ordnance Survey Ireland (osi.ie)  
© Ordnance Survey Ireland Government of Ireland  
**Order #50227993\_1**  
**Ordnance Survey Ireland**  
**Licence No.: AR 0027622**

| REV | DATE    | BY | DESCRIPTION         | CHKD |
|-----|---------|----|---------------------|------|
| A   | 18.2.22 | DM | ISSUED FOR PLANNING | DM   |

**NOTE** © This drawing is copyright. Figured dimensions only to be taken from this drawing. All dimensions to be checked on site. Architects to be informed immediately of any discrepancies before work proceeds.

**DOUGLAS WALLACE | CONSULTANTS**  
St. Kevin's Female School . 1 Grantham Street . Dublin 8  
T +353-1-478-7500 F +353-1-478-7590 E info@douglaswallace.com

**CLIENT** NOVOT HOLDINGS LIMITED  
**PROJECT** PROPOSED RESIDENTIAL DEVELOPMENT AT CAIRNS ROAD, SLIGO  
**TITLE** OS SITE LOCATION MAPS

| PROJ. NO. | DRG. NO.                | REVISION   |             |
|-----------|-------------------------|------------|-------------|
| 5470      | PL - 001                | A          |             |
| DRAWN     | SCALE                   | CHECKED BY | DATE        |
| DM        | 1:1,000 & 1:10,560 @ A1 | DM         | JAN. / 2022 |