

- 1. POLE TOP LUMINAIRES INSTALLED COMPLETE WITH INTEGRAL PHOTOCELL.
- 2. LIGHTING CABLED IN 3 X 16.0MMSQ XLPE/SWA/PVC/CU CABLE RATED FOR USE IN DUCTS. EXISTING CABLING SHALL BE LOCATED AND REMOVED. ALL LUMINAIRES SHALL BE RE CABLED.
- 3. LUMINAIRES SHALL BE SWITCHED THROUGH INTEGRAL PHOTOCELL IN EACH LUMINAIRE
- 4. THE ELECTRICAL CONTRACTOR SHALL SUPPLY, INSTALL, TEST AND COMMISSION ALL LIGHTING POLES, POLE TOP LUMINAIRES, POLE CUT-OUTS AND SUNDRY ITEMS
- 5. ALL ELECTRICAL WORKS SHALL BE CARRIED OUT IN STRICT ACCORDANCE WITH ET101:2008 NATIONAL RULES FOR ELECTRICAL INSTALLATIONS 4TH EDITION.
- 6. THE CONTRACTOR SHALL EMPLOY THE SERVICES OF A SPECIALIST STREET LIGHTING CONTRACTOR TO CARRY OUT THE SUPPLY AND INSTALLATION, TESTING, INSPECTION, COMMISSIONING AND HANDOVER OF THE STREET LIGHTING.
- 7. THE SPECIALIST STREET LIGHTING CONTRACTOR SHALL BE APPROVED BY THE IDA. THE CONTRACTOR SHALL EMPLOY "ELECTRIC SKYLINE" OR EQUIVALENT CONTRACTOR TO CARRY OUT THE WORKS.
- 8. THIS IS A LAYOUT DRAWING. DO NOT SCALE FROM THIS DRAWING. USE JENNINGS O DONAVAN DRAWINGS TO TAKE FIGURED DIMENSIONS. ACTUAL DIMENSIONS SHOULD BE MEASURED BY MEANS OF A SITE VISIT.
- 9. STREET LIGHTING POLES SHALL BE PAINTED BLACK. RAL TO BE CONFIRMED.

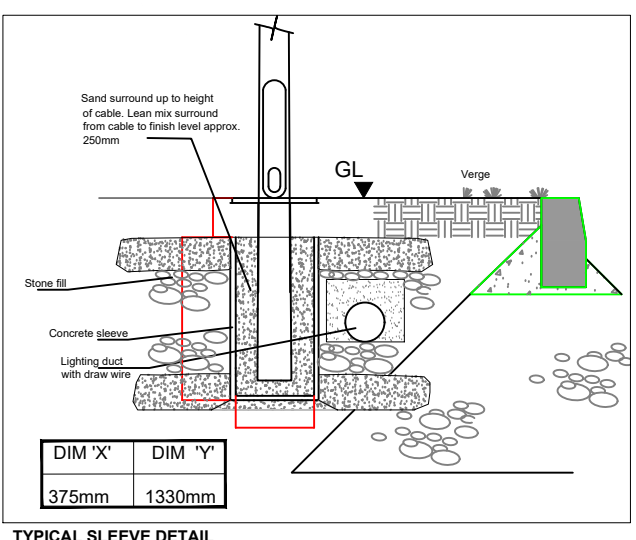
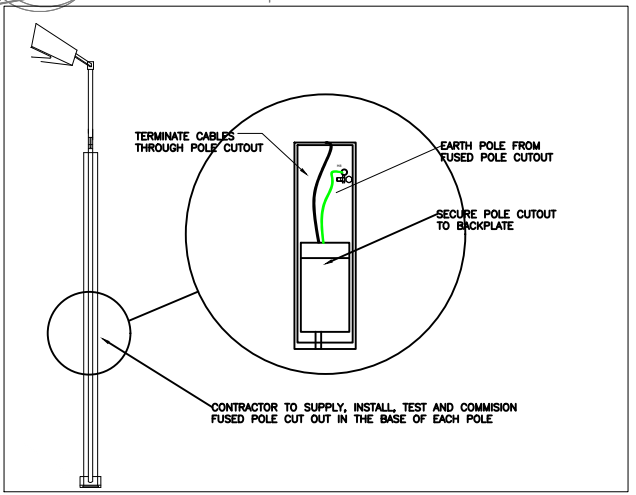
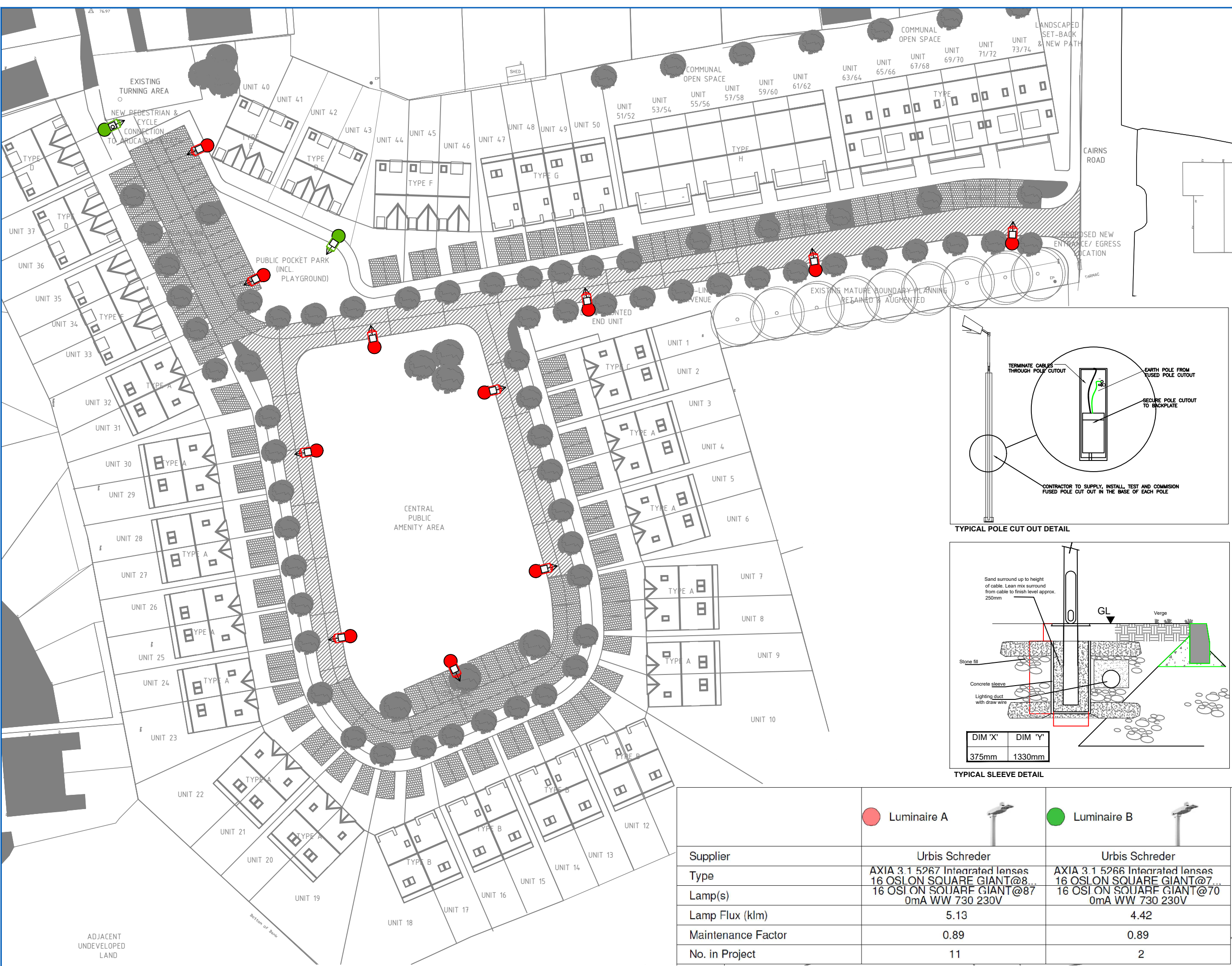

	● Luminaire A	● Luminaire B
Supplier	Urbis Schreder	Urbis Schreder
Type	AXIA 3.1 5267 Integrated lenses 16 OSLO SQUARE GIANT@8...	AXIA 3.1 5266 Integrated lenses 16 OSLO SQUARE GIANT@7...
Lamp(s)	16 OSI ON SQUARE GIANT@87 0mA WW 730 230V	16 OSI ON SQUARE GIANT@70 0mA WW 730 230V
Lamp Flux (klm)	5.13	4.42
Maintenance Factor	0.89	0.89
No. in Project	11	2

STREET LIGHTING SCHEDULE

A	For Information	RY	02.03.22
REV:	DESCRIPTION:	BY:	DATE:
STATUS:	For Information		

CBS Consulting Engineers
 MECHANICAL & ELECTRICAL ENGINEERS

CLIENT: Jennings O'Donovan & Partners
 Finisklin Business Park
 Sligo

SITE: Cairn Road
 Sligo

TITLE: STREET LIGHTING LAYOUT

SCALE AT A1:	DATE:	DRAWN:	CHECKED:
NTS	02.03.22	RY	RY
PROJECT NO:	DRAWING NO:	REVISION:	
	E800	A	