

NOTES :

All STOP signage line markings are to be thermo plastic and conform with the Department of Transport, Tourism and Sport Traffic Sign Manual.

All line markings are to be thermo plastic and in accordance with the Department of Transport, Tourism and Sport Traffic Sign Manual.

All signage to conform with the with the Department of Transport, Tourism and Sport Traffic Sign Manual.

REFER TO DRAWING 6665-JOD-007 FOR SECTION, ROAD AND FOOTPATH CONSTRUCTION DETAILS.

NOTE: CONTRACTOR TO REFER TO SITE INVESTIGATION REPORT FOR GROUND BUILD UP DETAILS

SITE DISTANCES PLAN
SCALE 1:250 @ A1

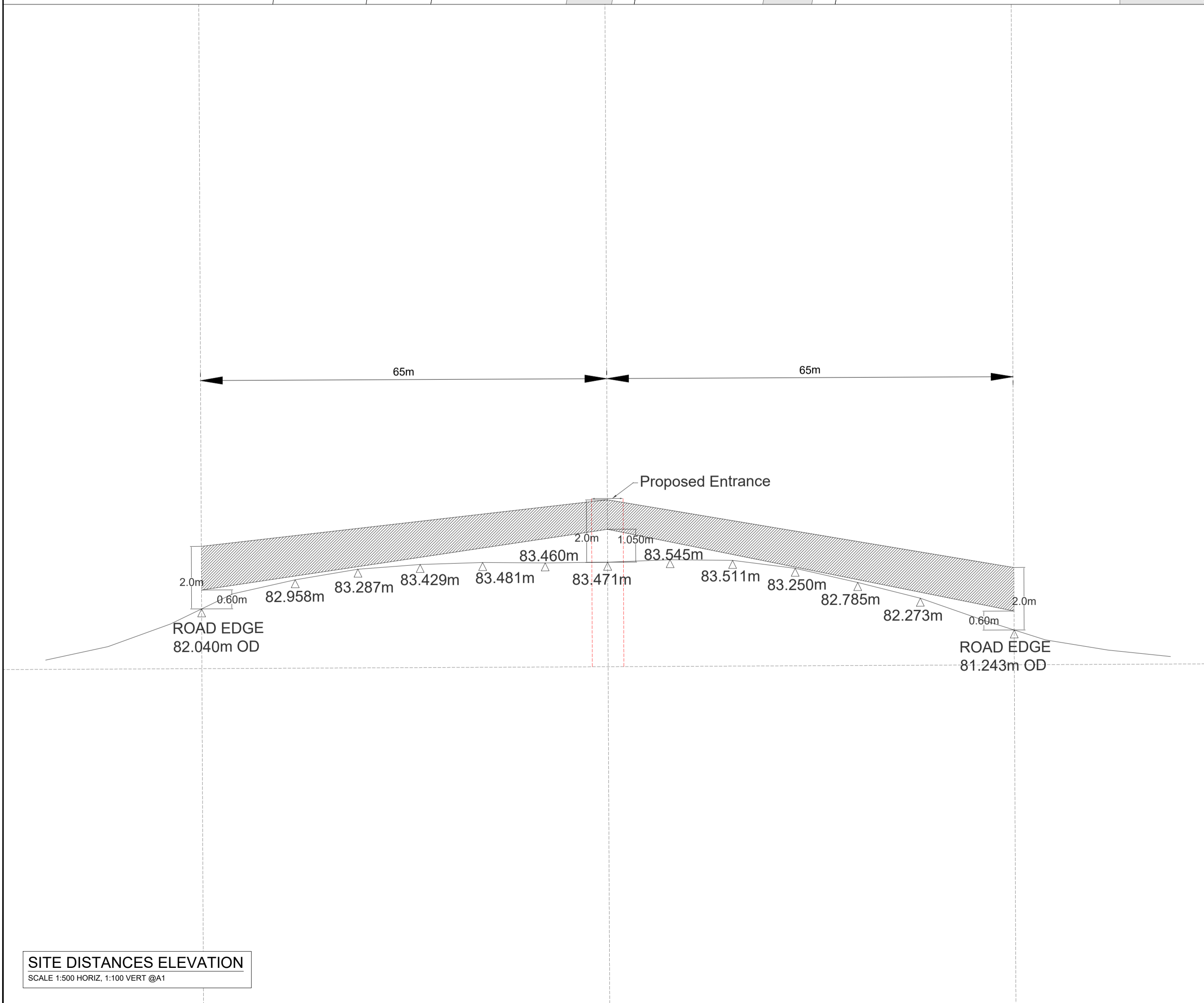
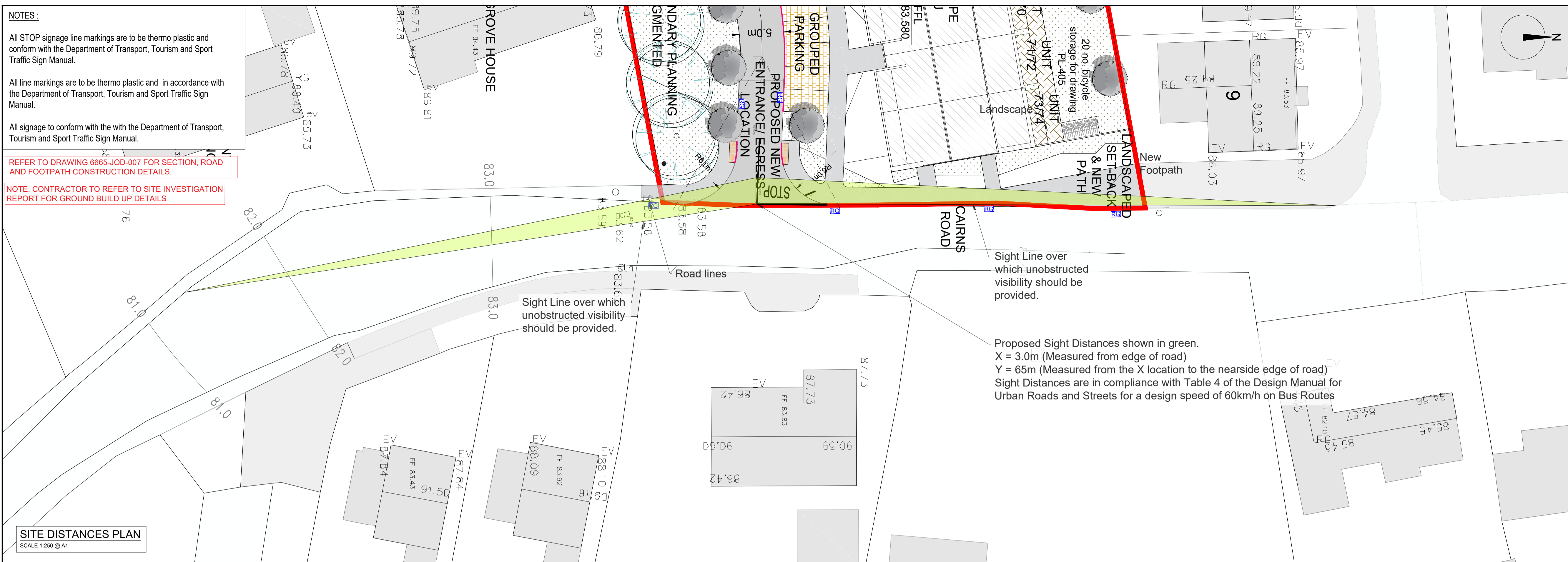

SITE DISTANCES ELEVATION
SCALE 1:500 HORIZ, 1:100 VERT @A1

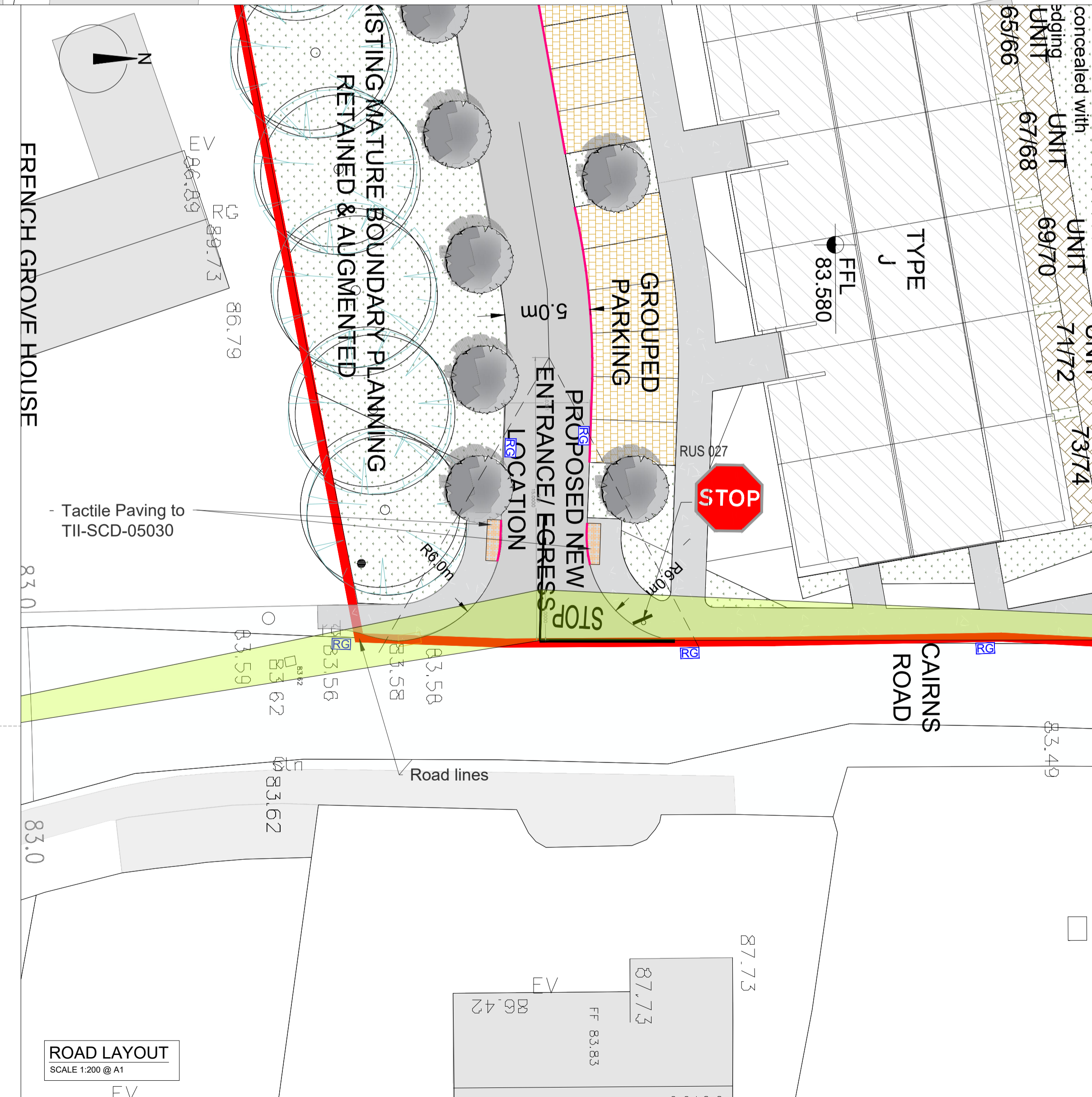

ROAD LAYOUT
SCALE 1:200 @ A1

NOTES

GENERAL NOTES:

- FIGURED DIMENSIONS ONLY TO BE TAKEN FROM THIS DRAWING.
- ALL DRAWINGS TO BE CHECKED BY THE CONTRACTOR ON SITE.
- ENGINEER/EMPLOYERS REPRESENTATIVE, AS APPROPRIATE, TO BE INFORMED BY THE CONTRACTOR OF ANY DISCREPANCIES BEFORE ANY WORK COMMENCES.
- THE CONTRACTOR SHALL UNDERTAKE A THOROUGH CHECK FOR THE ACTUAL LOCATION OF ALL SERVICES/UTILITIES, ABOVE AND BELOW GROUND, BEFORE ANY WORK COMMENCES.
- ALL LEVELS SHOWN RELATE TO ORDNANCE SURVEY DATUM AT MALIN HEAD.
- THIS DRAWING IS TO BE READ IN CONJUNCTION WITH ALL OTHER RELEVANT DRAWINGS AND SPECIFICATIONS. CONTRACTOR TO VERIFY THE ACCURACY OF THIS PROPOSAL TO THE ENGINEER AND ALLOW FOR MINOR CORRECTIONS AS DEEMED NECESSARY WITH A REASONABLE TIMEFRAME.

LEGEND

SITE BOUNDARY	
STOP SIGN	
SIGN & POST	
PRIORY CONTROLLED JUNSTION. REFER TO TSM FIG 7.35.	
PROPOSED ROADWAY (AREA = 1922m ²) - REFER TO DRAWING 6665-JOD-007 FOR ROAD BUILD UP DETAIL	
PROPOSED FOOTPATH	
PROPOSED SHARED ROADWAY	
PROPOSED LANDSCAPING	
PROPOSED PARKING	
PRECAST DROP KERBING	
PROPOSED RAISED CROSSING	

Site Area:-
21,000 m², 5.189 Acres, 2.1 Hectares
ITM Co-Ordinates of site:-
569700, 833700
Ordnance Survey Ireland Licence No. CYAL50244098
© Ordnance Survey Ireland/Government of Ireland.
OS Sheet No.1071-A

P.01	Issued for Planning	AP	MF	04.03.22
rev.	modifications	by	chkd	date
Layout Ref.:				
file	P:\jod-jobs\6665 Cairns Hill Hsng\700 Drawings\703 Planning\01 WIP\6665-JOD-XX-ZZ-DR-C-700-008 Sight Distances Layout.dwg			

client
NOVOT HOLDINGS LIMITED

project
PROPOSED RESIDENTIAL DEVELOPMENT AT CAIRNS ROAD, CO. SLIGO

stage
PLANNING

title
PROPOSED SIGHT DISTANCES LAYOUT

scale
AS SHOWN @ A1

surveyed	drawn	checked	date
JOD	AP	MF	March 2022

© COPYRIGHT OF
JENNINGS O'DONOVAN & PARTNERS CONSULTING ENGINEERS, FINISKLIN, SLIGO, IRELAND.

TEL. +353 (0)71 916 1416
FAX. +353 (0)71 916 1080
Email: info@jodireland.com

drawing no.	revision
6665-JOD-XX-ZZ-DR-C-700-008	P.01