

**NOTES :**

All STOP signage line markings are to be thermo plastic and conform with the Department of Transport, Tourism and Sport Traffic Sign Manual.

All line markings are to be thermo plastic and in accordance with the Department of Transport, Tourism and Sport Traffic Sign Manual.

All signage to conform with the Department of Transport, Tourism and Sport Traffic Sign Manual.

REFER TO DRAWING 6665-JOD-007 FOR SECTION, ROAD AND FOOTPATH CONSTRUCTION DETAILS.

NOTE: CONTRACTOR TO REFER TO SITE INVESTIGATION REPORT FOR GROUND BUILD UP DETAILS

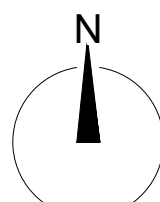

**NOTES**

- GENERAL NOTES:**
- FIGURED DIMENSIONS ONLY TO BE TAKEN FROM THIS DRAWING.
  - ALL DRAWINGS TO BE CHECKED BY THE CONTRACTOR ON SITE.
  - ENGINEER/EMPLOYERS REPRESENTATIVE, AS APPROPRIATE, TO BE INFORMED BY THE CONTRACTOR OF ANY DISCREPANCIES BEFORE ANY WORK COMMENCES.
  - THE CONTRACTOR SHALL UNDERTAKE A THOROUGH CHECK FOR THE ACTUAL LOCATION OF ALL SERVICES/UTILITIES, ABOVE AND BELOW GROUND, BEFORE ANY WORK COMMENCES.
  - ALL LEVELS SHOWN RELATE TO ORDNANCE SURVEY DATUM AT MALIN HEAD.
  - THIS DRAWING IS TO BE READ IN CONJUNCTION WITH ALL OTHER RELEVANT DRAWINGS AND SPECIFICATIONS. CONTRACTOR TO VERIFY THE ACCURACY OF THIS PROPOSAL TO THE ENGINEER AND ALLOW FOR MINOR CORRECTIONS AS DEEMED NECESSARY WITH A REASONABLE TIMEFRAME.

**LEGEND**

SITE BOUNDARY	
STOP SIGN	
SIGN & POST	
PRIORY CONTROLLED JUNSTION. REFER TO TSM FIG 7.35.	
PROPOSED ROADWAY (AREA = 1922m <sup>2</sup> ) - REFER TO DRAWING 6665-JOD-007 FOR ROAD BUILD UP DETAIL	
PROPOSED FOOTPATH	
PROPOSED SHARED ROADWAY	
PROPOSED LANDSCAPING	
PROPOSED PARKING	
PRECAST DROP KERBING	
PROPOSED RAISED CROSSING TO COMPLY WITH ITEM 3.3.1 OF ROAD SAFETY AUDIT	

Site Area:-  
21,000 m<sup>2</sup>, 5.189 Acres, 2.1 Hectares  
ITM Co-Ordinates of site:-  
569700, 833700  
Ordnance Survey Ireland Licence No. CYAL50244098  
© Ordnance Survey Ireland/Government of Ireland.  
OS Sheet No.1071-A

P.01 Issued for Planning	AP	MF	04.03.22
rev. modifications		by chkd	date
Layout Ref.:			
file	P:\jod-jobs\6665 Cairns Hill Hsing\700 Drawings\703 Planning\01 WIP\6665-JOD-XX-ZZ-DR-C-700-006 Road Layout Plan.dwg		

client  
**NOVOT HOLDINGS LIMITED**

project  
**PROPOSED RESIDENTIAL DEVELOPMENT AT CAIRNS ROAD, CO. SLIGO**

stage  
**PLANNING**

title  
**PROPOSED ROAD LAYOUT PLAN**

scale  
**1:500 @ A1**

surveyed	drawn	checked	date
JOD	AP	MF	March 2022

© COPYRIGHT OF  
**JENNINGS O'DONOVAN & PARTNERS**  
CONSULTING ENGINEERS,  
FINISKILIN,  
SLIGO,  
IRELAND.  
TEL. +353 (0)71 916 1416  
FAX. +353 (0)71 916 1080  
Email: info@jodireland.com

drawing no.	revision
6665-JOD-XX-ZZ-DR-C-700-006	P.01

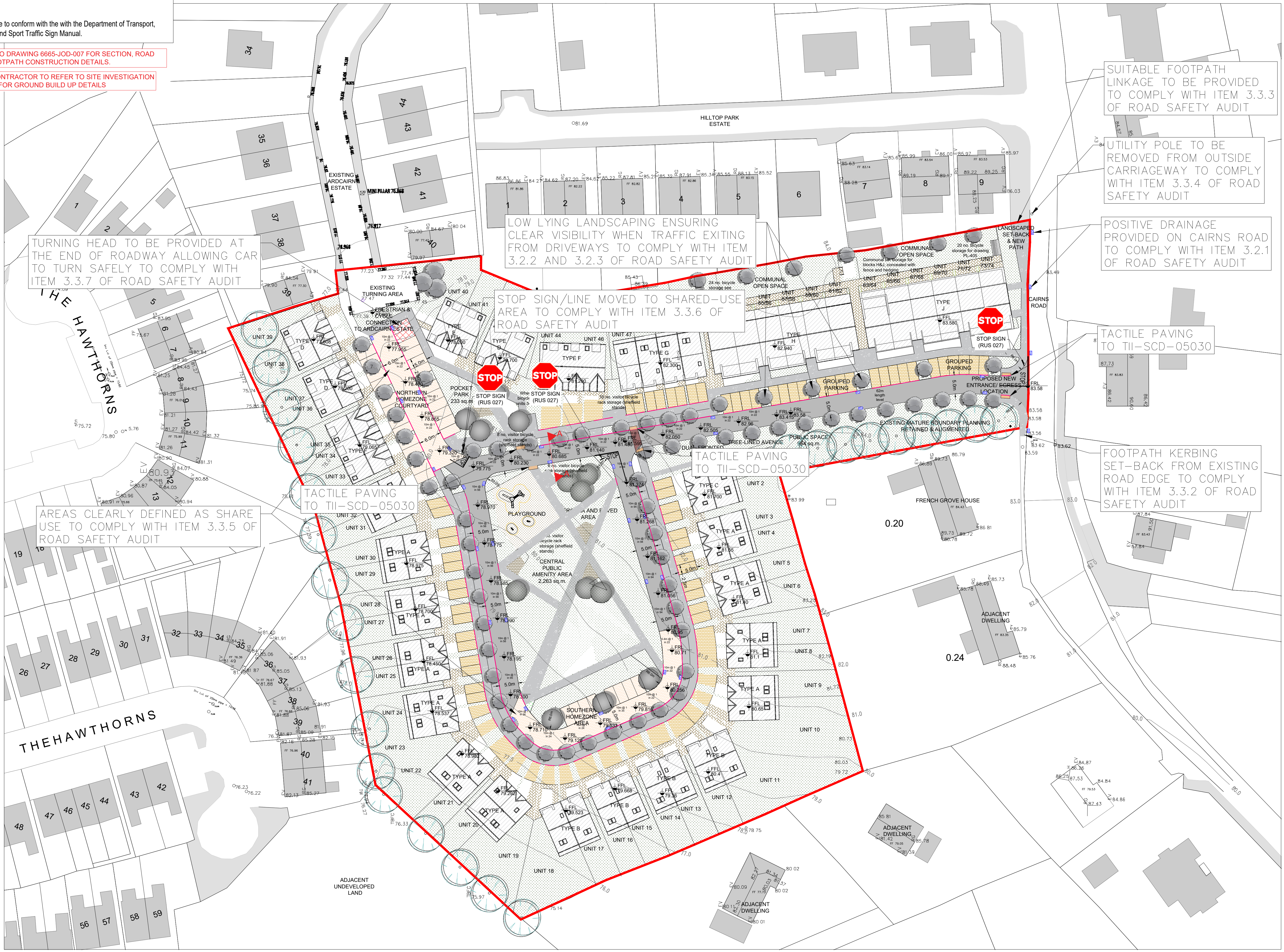

TURNING HEAD TO BE PROVIDED AT THE END OF ROADWAY ALLOWING CAR TO TURN SAFELY TO COMPLY WITH ITEM 3.3.7 OF ROAD SAFETY AUDIT

LOW LYING LANDSCAPING ENSURING CLEAR VISIBILITY WHEN TRAFFIC EXITING FROM DRIVEWAYS TO COMPLY WITH ITEM 3.2.2 AND 3.2.3 OF ROAD SAFETY AUDIT

STOP SIGN/LINE MOVED TO SHARED-USE AREA TO COMPLY WITH ITEM 3.3.6 OF ROAD SAFETY AUDIT

SUITABLE FOOTPATH LINKAGE TO BE PROVIDED TO COMPLY WITH ITEM 3.3.3 OF ROAD SAFETY AUDIT

UTILITY POLE TO BE REMOVED FROM OUTSIDE CARRIAGEWAY TO COMPLY WITH ITEM 3.3.4 OF ROAD SAFETY AUDIT

POSITIVE DRAINAGE PROVIDED ON CAIRNS ROAD TO COMPLY WITH ITEM 3.2.1 OF ROAD SAFETY AUDIT

TACTILE PAVING TO TI-SCD-05030

FOOTPATH KERBING SET-BACK FROM EXISTING ROAD EDGE TO COMPLY WITH ITEM 3.3.2 OF ROAD SAFETY AUDIT

AREAS CLEARLY DEFINED AS SHARE USE TO COMPLY WITH ITEM 3.3.5 OF ROAD SAFETY AUDIT

TACTILE PAVING TO TI-SCD-05030

TACTILE PAVING TO TI-SCD-05030

**PROPOSED ROAD LAYOUT PLAN**  
SCALE 1:500 @ A1